

KEY PLAN

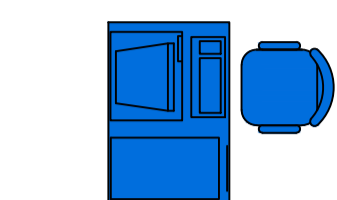

ADAPTABILITY OF INTERNAL APARTMENT LAYOUTS FOR HOMEWORKING / STUDYING i.e. POTENTIAL DESK LOCATION

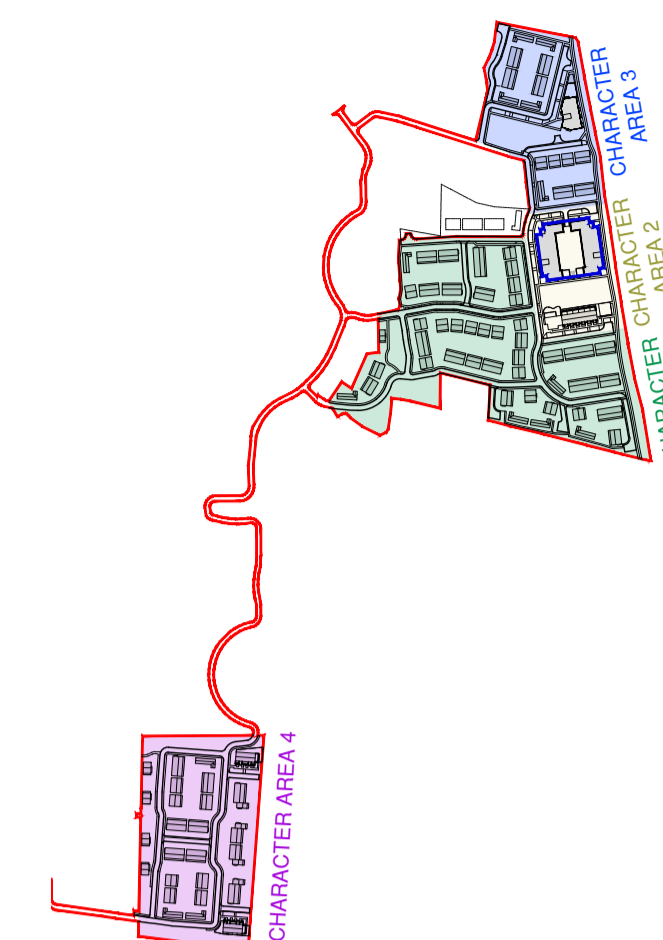
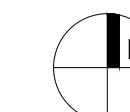
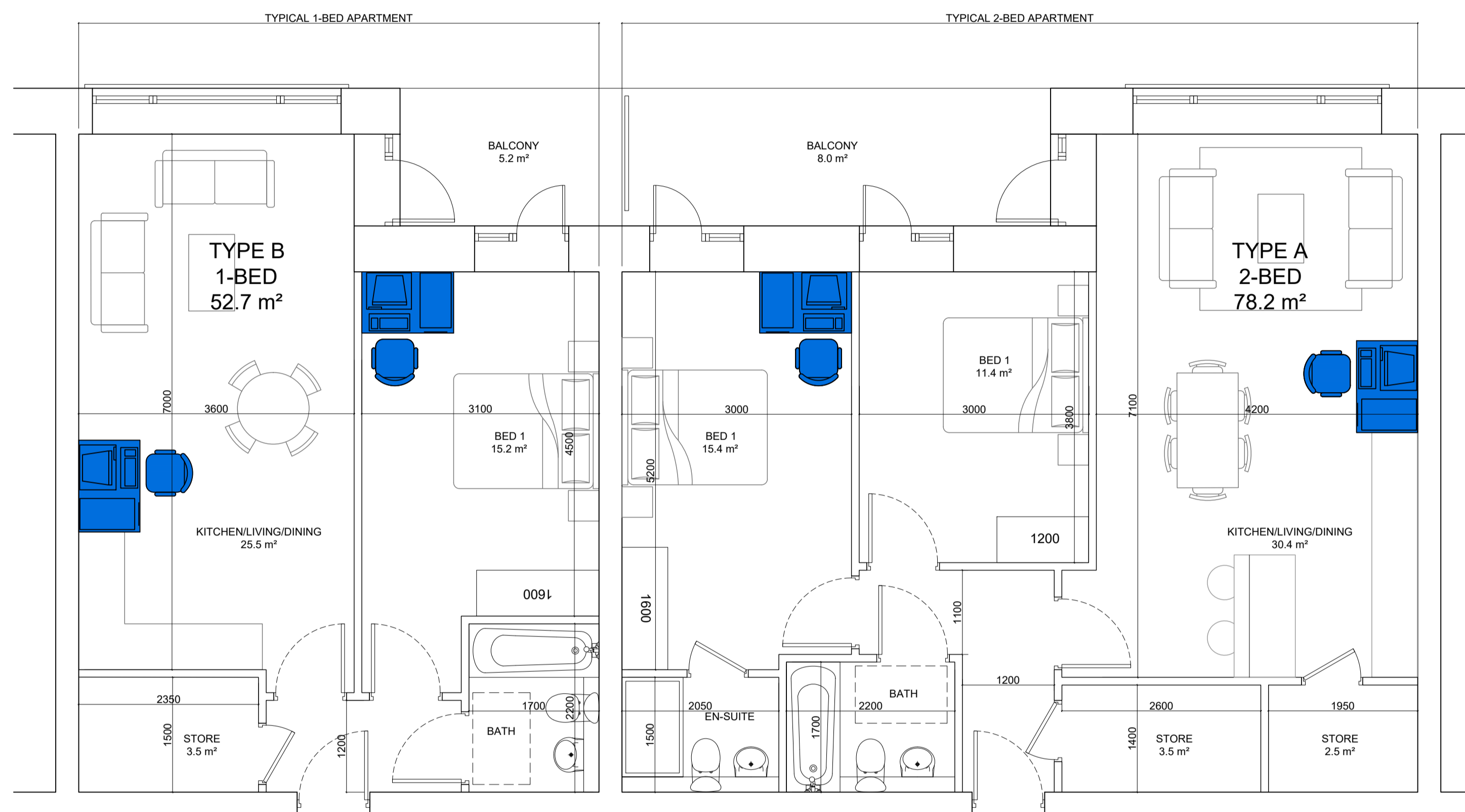

TYPICAL FLOOR PLAN ARRANGEMENT - POTENTIAL DESK LOCATIONS

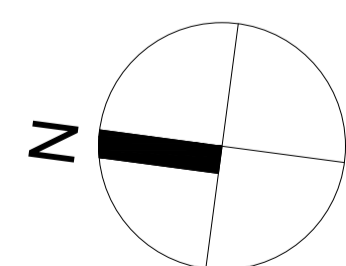

UNITS SHOWN FOR ILLUSTRATIVE PURPOSES ONLY. NORTH POINT WILL VARY DEPENDING ON LOCATION OF UNIT.

NOTES:

DO NOT SCALE FROM DRAWINGS. WORK TO FIGURED DIMENSIONS ONLY. ARCHITECT TO BE NOTIFIED OF ALL DISCREPANCIES.

REVISIONS		
DATE	DESCRIPTION	No.

	PROJECT TITLE:	BROOMFIELD, BACK ROAD, MALAHIDE	DATE:	FEB 22	DRAWN BY:	POR
	DRAWING TITLE:	APARTMENT BLOCK A & B UNIT ADAPTABILITY	SCALE:	1:50	REVISION:	-
<small>1 Grantham Street, Dublin 8, D08 A49Y, Ireland. Tel: 01-4788700 Fax: 01-4788711 E-Mail: arch@mcorm.com</small>		JOB NO:	18034	DRAWING NO:	PL210	